

## Specification

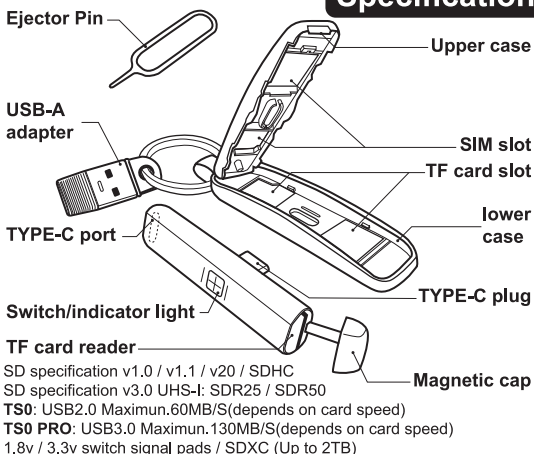

1. Do not disassemble.

2. Avoid water or moisture when using and storing.

3. Keep away from kids.

4. TYPE-C port is specifically for charging.

Not for accessing data.



5. Please unplug the TOFUstick at horizontal direction as shown in image.

6. Please insert the TOFUstick fully during use.

7. Do not use when type C head/ port is damaged.

8. Do not insert sharp objects into the port and plug.



## Attention

### How to insert TF card

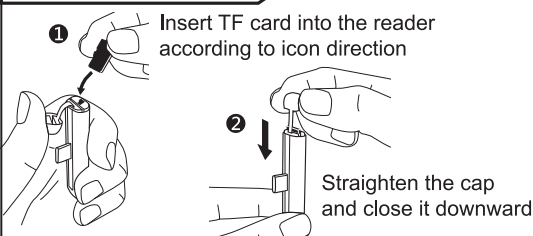

### Storing SIM card

- ◆Storage:  
Remove ejector pin.  
Place SIM card in the slot of the upper case.

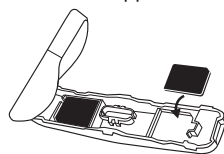

### Instruction

- ◆Remove: With ejector pin, pry the SIM card out from the notch of slot

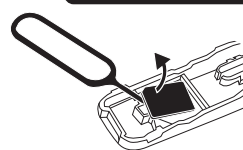

### How to charge device with TOFUstick

- A** Plug TOFUstick into device and connect the power
- B** Connect power to TOFUstick and plug it into the device

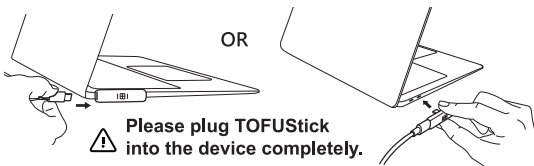

### Storing ejector pin

Place the ejector pin in the elliptical protrusion

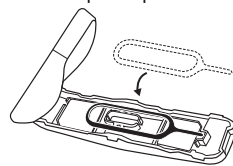

### Storing TF card

Place TF card on the elliptical hole of lower case, and push it parallelly into the slot

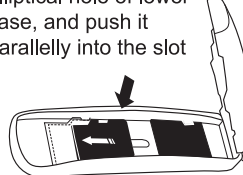

### How to use USB-A adapter

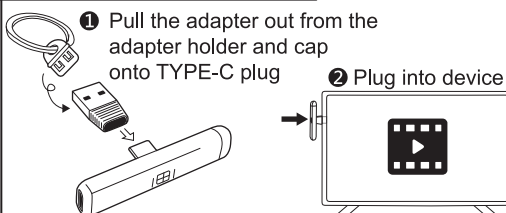

### Indicator light for data accessing and ejecting

For power saving, when TOFUstick is plugged into mobile device, power needs to be turned on and off manually.

**Indicator light is on** data access and transfer are available

**Indicator light is off** TOFUstick is off mode

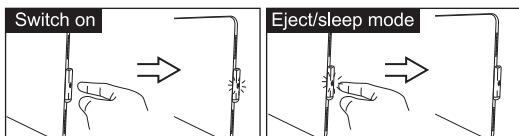

Long press the power switch for 1 second.  
The red light shows up.

Long press the power switch for 3 seconds.  
The Red light goes off.

### How to remove TOFUstick

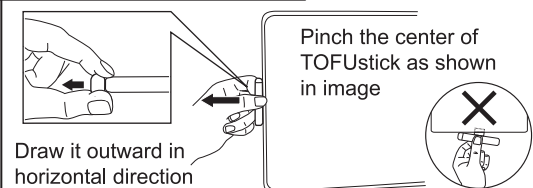

### ◆ Why can't the device access the data from TOFUstick?

First, please check if the indicator light is on. Check if it is fully plugged into the device. Then, check if the TF card is well inserted, or if the device supports TOFUstick.



### ◆ Can I connect lightning adapter with TOFUstick to access data through iPhone?

No, iPhone doesn't support external data access.

### ◆ Why can't TF card be inserted into card reader?

TF card might be inserted in the wrong direction. Please refer to "How to insert TF card" and try again.

### ◆ Can I charge my laptop with power of 100 Watts through TOFUstick?

Yes. The electric power does not affect TOFUstick. Please check the electric power advice for the device.

### ◆ Does TOFUstick come with internal storage capacity?

There is no internal storage capacity in TOFUstick. TOFUstick supports TF card with maximum capacity of 2TB.

### ◆ How to fix the cap if it comes off from TOFUstick?

The cap can be re-attached onto TOFUstick. Please follow the instruction image.

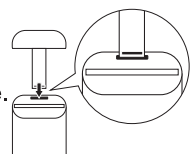

## FAQ